

THIS DRAWING IS UNPUBLISHED. RELEASED FOR PUBLICATION  
 © COPYRIGHT - By - ALL RIGHTS RESERVED.

LOC	DIST	REVISIONS					
CM	00	P	LTR	DESCRIPTION	DATE	DWN	APVD
		F		REVISED PER ECO-12-007610	25JUL12	KH	SM

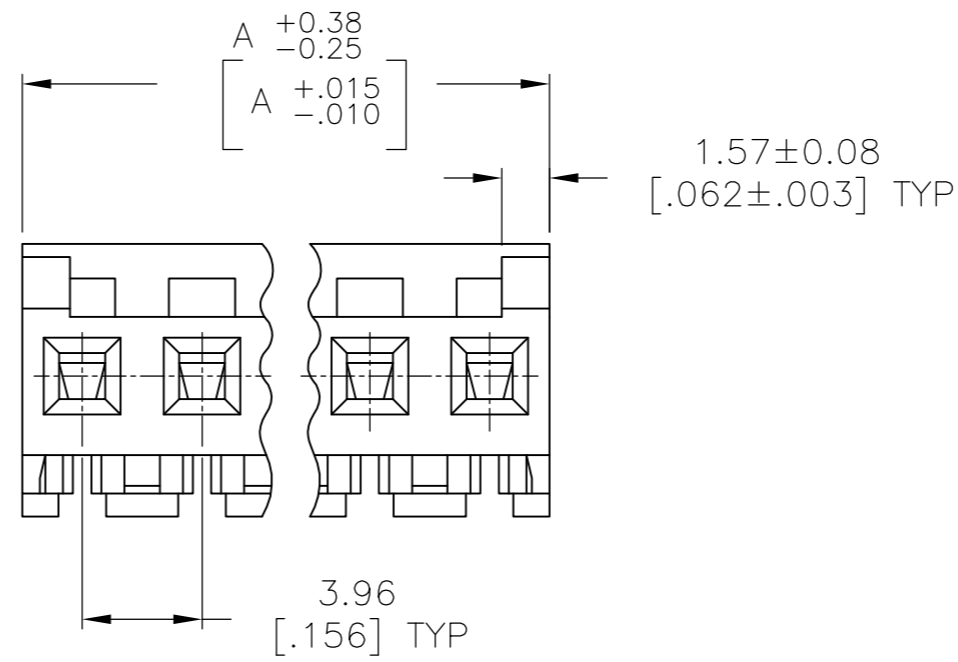
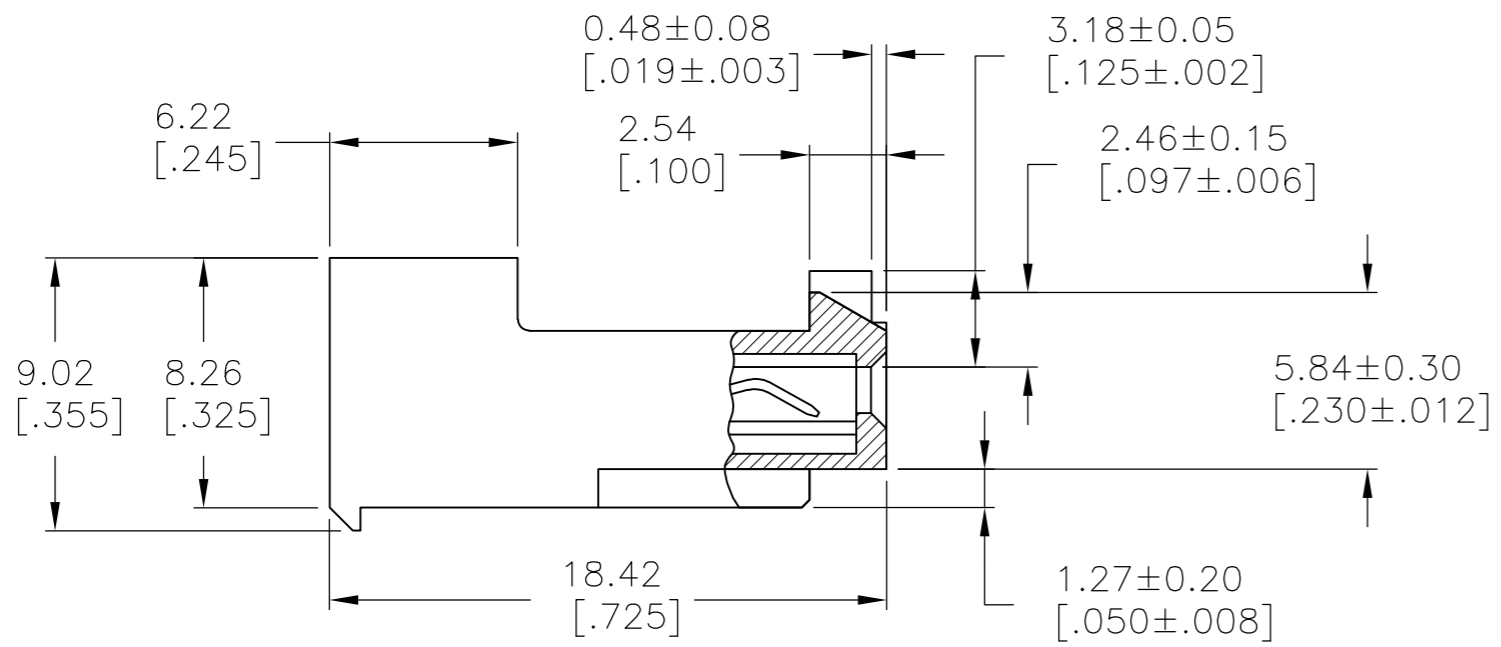
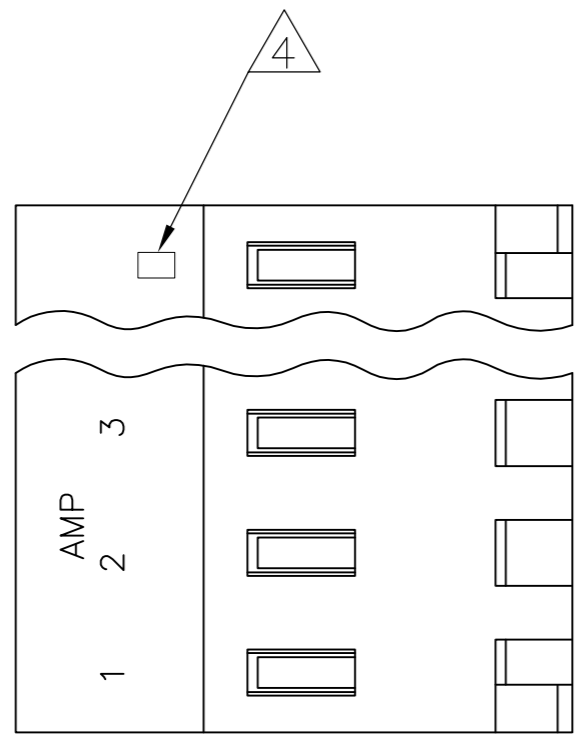

DIM A	NO OF CIRCUITS	PART NO
55.47 [2.184]	14	4-644662-4
47.55 [1.872]	12	4-644662-2
43.59 [1.716]	11	4-644662-1
39.62 [1.560]	10	4-644662-0
35.66 [1.404]	9	3-644662-9
31.70 [1.248]	8	3-644662-8
27.74 [1.092]	7	3-644662-7
23.77 [.936]	6	3-644662-6
19.81 [.780]	5	3-644662-5
15.85 [.624]	4	3-644662-4
11.89 [.468]	3	3-644662-3
7.92 [.312]	2	3-644662-2
55.47 [2.184]	14	<del>1-644662-4</del>
47.55 [1.872]	12	<del>1-644662-2</del>
43.59 [1.716]	11	<del>1-644662-1</del>
39.62 [1.560]	10	1-644662-0
35.66 [1.404]	9	644662-9
31.70 [1.248]	8	644662-8
27.74 [1.092]	7	<del>644662-7</del>
23.77 [.936]	6	644662-6
19.81 [.780]	5	644662-5
15.85 [.624]	4	644662-4
11.89 [.468]	3	644662-3
7.92 [.312]	2	644662-2
DIM A	NO OF CIRCUITS	PART NO

1 MATERIAL: CONNECTOR - NYLON UL94V-2 .  
 CONTACTS - 0.30[.012] THICK COPPER ALLOY  
 0.00076[.000030] GOLD THK OR 0.00008[.000003] MIN THK  
 GOLD FLASH OVER 0.00068[.000027] THK PALLADIUM NICKEL,  
 PER TE CONNECTIVITY'S DISCRETION. IN CONTACT  
 AREA WITH BRIGHT TIN-LEAD FOR 644662-2  
 THRU 1-644662-4, MATTE WHISKER MITIGATED  
 TIN FOR 3-644662-2 THRU 4-644662-4  
 OVER NICKEL UNDERPLATE.

2 CONTACTS ACCEPT 22 AWG WIRE WITH 2.41[.095] MAX  
 INSULATION DIAMETER.

3 CONTACTS MUST ACCEPT 1.14±0.03[.045±.001] SQUARE  
 POST AND REMAIN LOCKED IN POSITION.

4 IDENTIFICATION NUMBER FOR LAST CIRCUIT MAY  
 NOT APPEAR ON ALL ASSEMBLIES.

5 DIMENSIONS IN BRACKETS ARE IN INCHES.

6 HOUSING FEATURES ARE: CLOSED END WITH LOCKING RAMP  
 AND POLARIZING TAB

7 OBSOLETE PARTS: OBSOLETE CIS STREAMLINING PER D.RENAUD/D.SINISI

8 RED COLOR STRIPE ON HOUSING (NOT SHOWN) MAY RUN DOWN BETWEEN RIBS.

7 SUPERSEDED BY 4-644662-4

7 SUPERSEDED BY 4-644662-2

7 SUPERSEDED BY 4-644662-1

7 SUPERSEDED BY 3-644662-7

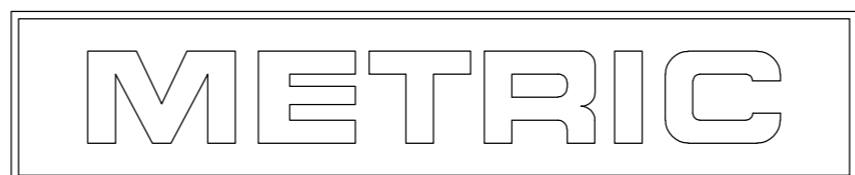

THIS DRAWING IS A CONTROLLED DOCUMENT.		DWN N. GANNON 03 JUL 91			
DIMENSIONS: mm [INCHES]		CHK R. SWING 03 JUL 91			
TOLERANCES UNLESS OTHERWISE SPECIFIED:		APVD G. MILLER 03 JUL 91	NAME MTA-156 CONNECTOR ASSEMBLY, 22 AWG, STANDARD		
0 PLC ± - 1 PLC ± - 2 PLC ± - 3 PLC ± 0.13 [.005] 4 PLC ± -		PRODUCT SPEC 108-1051	SIZE A2	CAGE CODE 00779	DRAWING NO C-644662
MATERIAL 1		FINISH 1	WEIGHT -	RESTRICTED TO -	
CUSTOMER DRAWING			SCALE 4:1	SHEET 1 OF 1	REV F